



# Technical Data Sheet

## Bennington 8350 Side Door Latch Upgrade Kit #93-73508

**Publish Date: 3/27/2006**

### **MATERIALS REQUIRED:**

Latch (5350-039)  
Crank (5010-081)  
Brass Spacer (4700-0790), 4 ea.  
Spring (5240-138)  
Washer (5021-032)  
Setscrew (4500-2976)

### **TOOLS REQUIRED:**

Phillips screwdriver  
5/32" Hex wrench

### **OTHER MATERIALS:**

Needed for Bennington models made prior to September 2005 with serial numbers lower than 3115.

Side Door Catch (5350- 038)  
1/8" Spacer (4700-0810)

### **PROCEDURE:**

- 1) Remove and discard the side door latch assembly by loosening the two setscrews.
- 2) On models built before September 2005 (serial numbers below 3115), remove and discard the side door catch only by removing the two Phillips head screws.
- 3) Install the new catch using the screws removed in step #2 inserting the 1/8" spacer behind the left side of the catch (as shown on sheet 2).
- 4) Install the new latch assembly as shown on sheet 2. Start out with one brass spacer ring on the latch shaft inside of the door. With the latch shaft extending through the door, place the washer and coil spring on the latch shaft on the outer side of the door. The chrome crank can now be threaded onto the latch. Turn the crank until there is approximately 1/8" between the crank and the washer.
- 5) Align the setscrew hole in the crank with the flat on the latch shaft and insert and tighten the setscrew with the 5/32 hex wrench.
- 6) Check door seals using the "dollar bill test." Shut the door on a dollar bill. If the bill pulls out without any resistance, then your stove's door isn't sealed properly. Spacers can be added or removed to adjust pressure on the gasket.

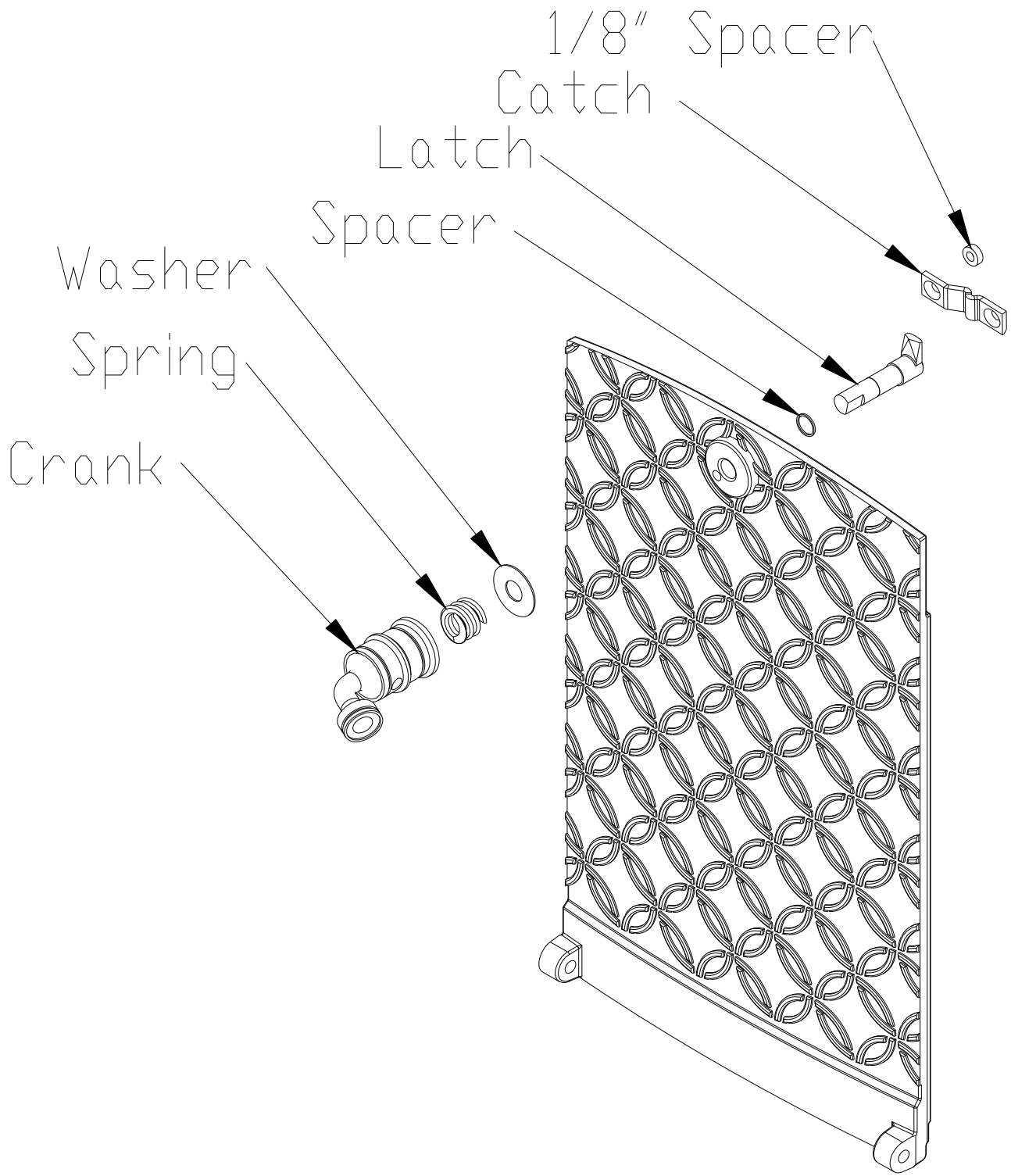

**Figure 1: Latch Upgrade Components**